

4

3

2

1

RESPIRO 6"

EXTRAVASOR 1 1/2"

ENTRADA 1 1/2"

ENTRADA 1 1/2"

EXTRAVASOR 1 1/2"

SAÍDA 1 1/2"

DRENO 1 1/2"

PROJETISTA

Isabeli

10/11/2023

FAZ FORTE RESERVATORIOS METALICOS

NOME EMPRESA:

**TCS 80m<sup>3</sup>**

9077,970 kg

SIZE

C

DWG NO

TCS 80m<sup>3</sup>

REV

SCALE

SHEET 1 OF 5

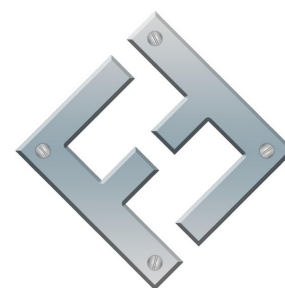

**FAZFORTE**

D

D

C

C

B

B

A

A

4

3

2

1

4

3

2

1

D

D

RESPIRO 6"

EXTRAVASOR 1 1/2"

ENTRADA 1 1/2"

C

C

B

B

ENTRADA 1 1/2"

EXTRAVASOR 1 1/2"

SAÍDA 1 1/2"

DRENO 1 1/2"

A

A

4

3

2

1

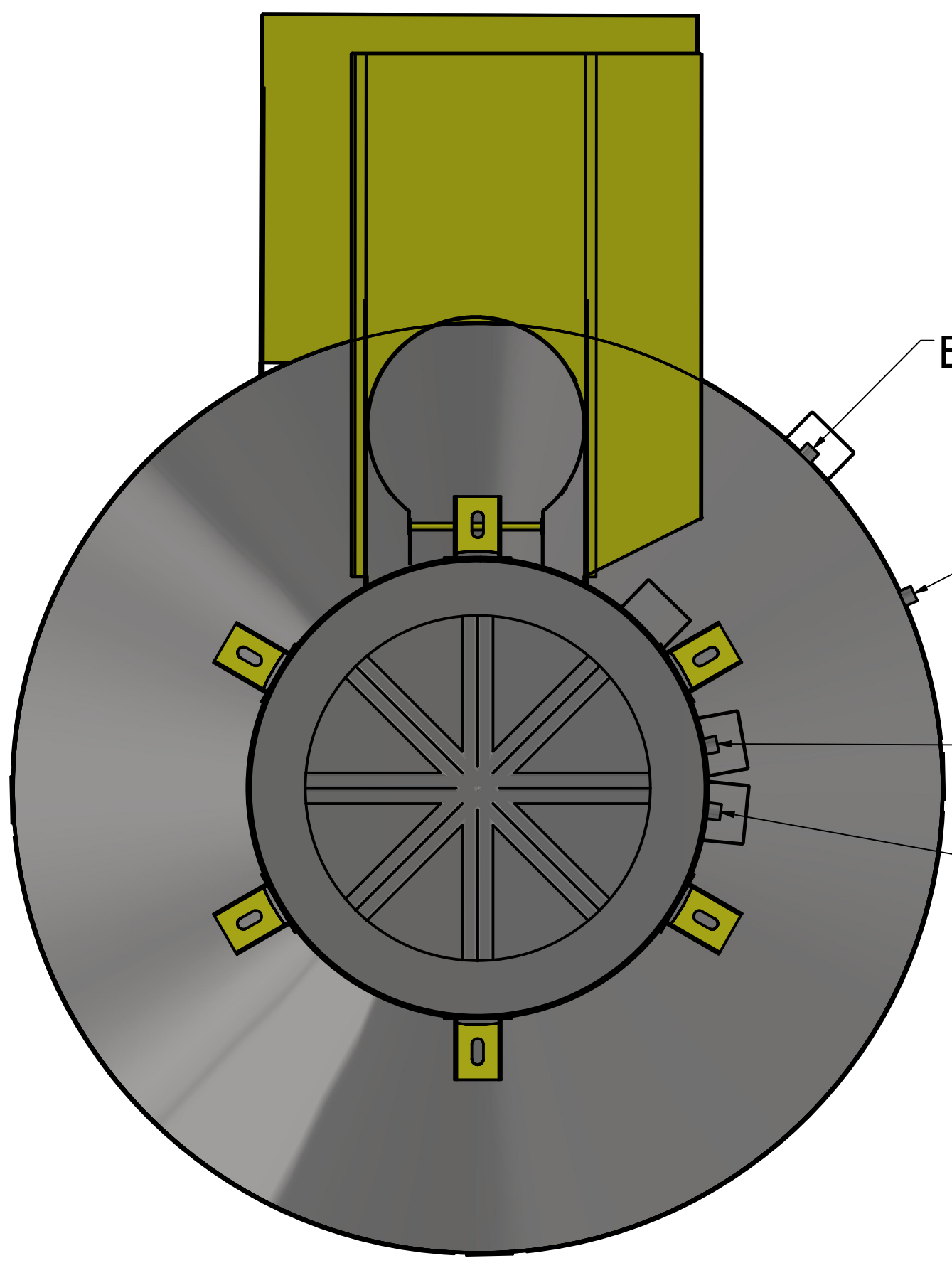
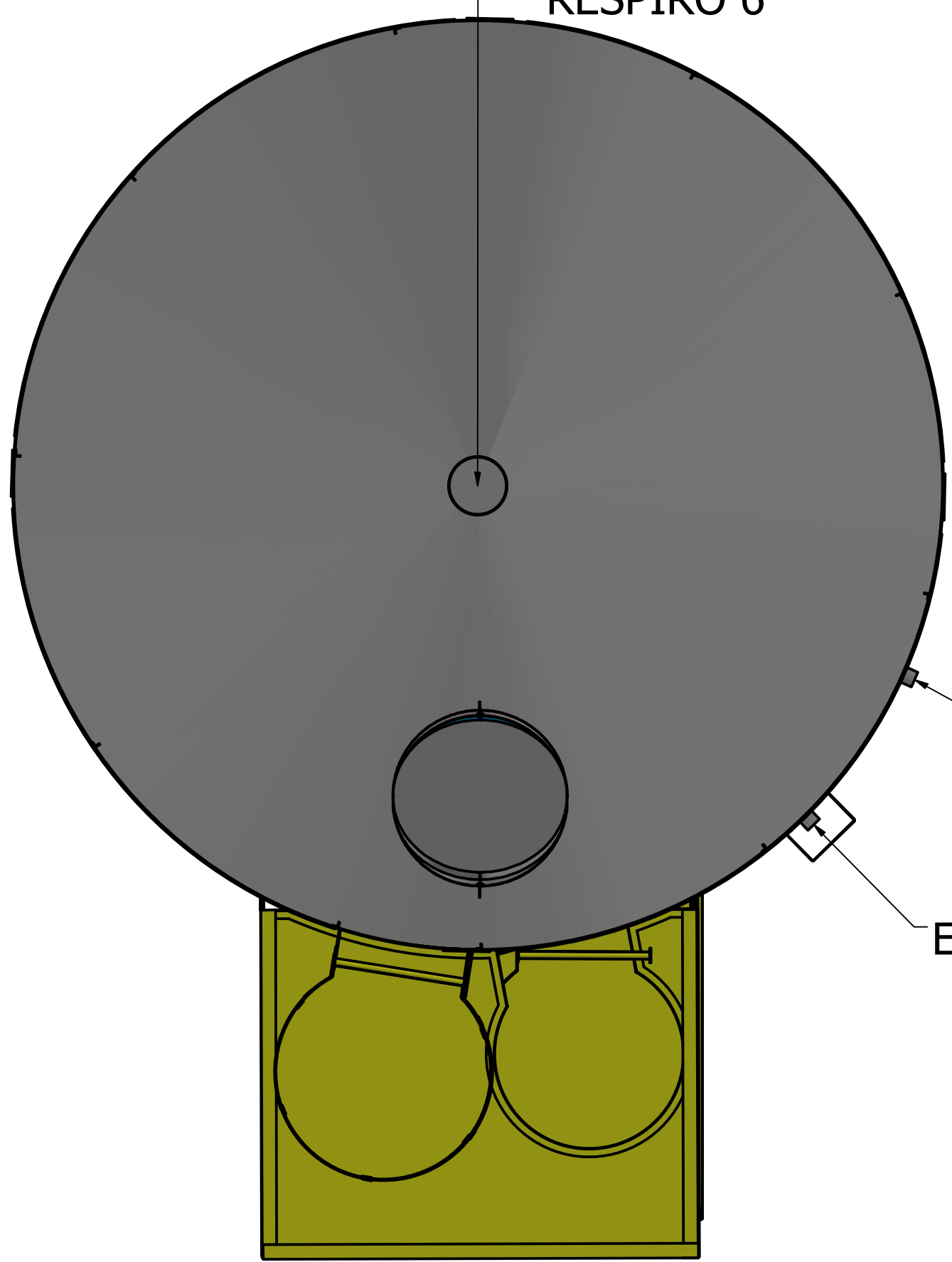

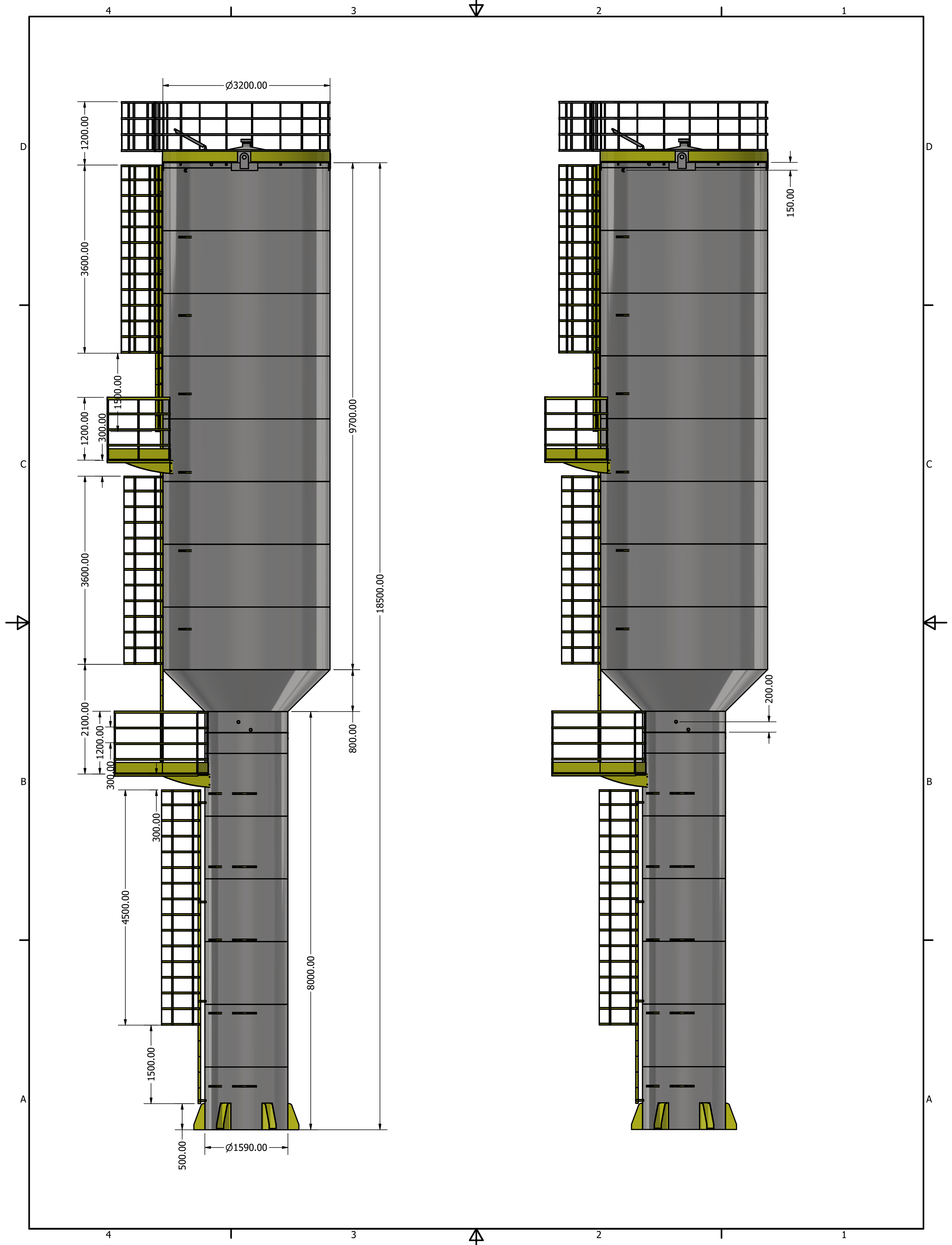

4

3

2

1

## LISTA DE PEÇAS

ITEM	QTD	NÚM. DE PEÇA	MASSA
1	1	TCS 8003 CASCA	8280,260 kg
2	4	orelha guindaste	3,338 kg
3	4	ISO 4144 - Bolsa S2 1 1/2	0,322 kg
4	21	suporte tubulação	0,285 kg
11	6	pes 500 mm altura	13,139 kg
13	1	BOCA INSPEÇÃO 600 MM + PESCOÇO	8,950 kg
15	1	RESPIRO 6POL	1,899 kg
29	1	LANCE 01 ESCADA NR12	91,729 kg
30	1	PATAMAR QUADRADO LONGO NR12	89,561 kg
31	1	LANCE 02 ESCADA NR12	95,190 kg
33	1	LANCE 03 ESCADA NR12	76,697 kg
34	1	PATAMAR 3200 QUADRADO	97,759 kg
35	1	GRADE SEGURANÇA 3200	55,145 kg
36	1	RODAPÉ 200mm #2,00	87,142 kg
37	31	Degrau sem guarda corpo	2,941 kg
38	1	DEGRAU	1,805 kg
39	10	SUPORTE PARAFUSO ESCADA	0,120 kg

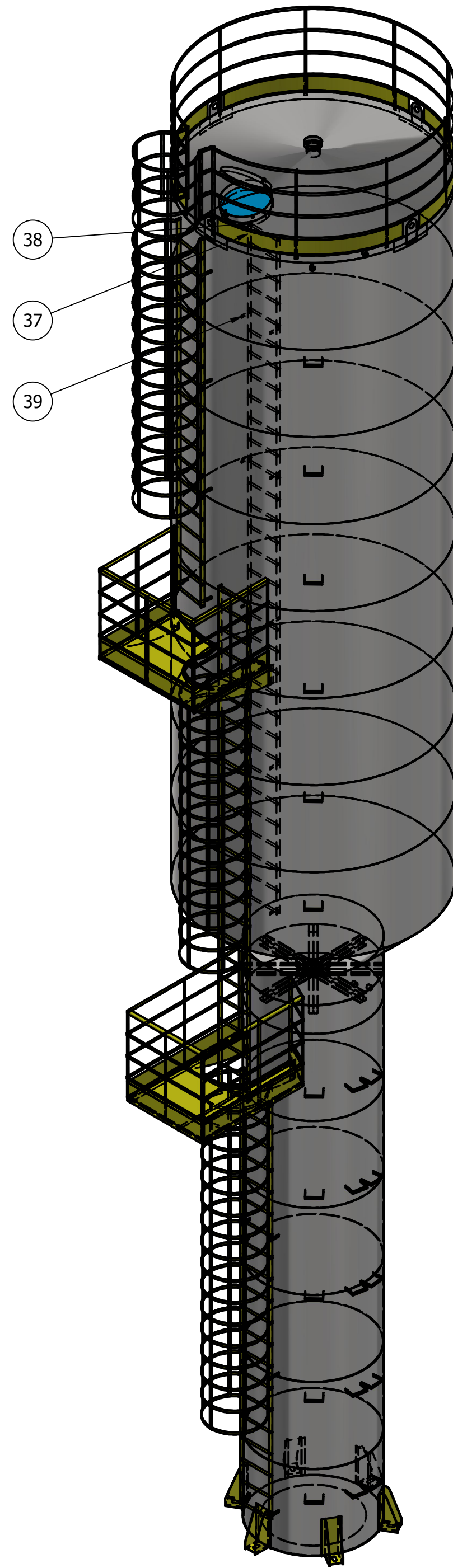
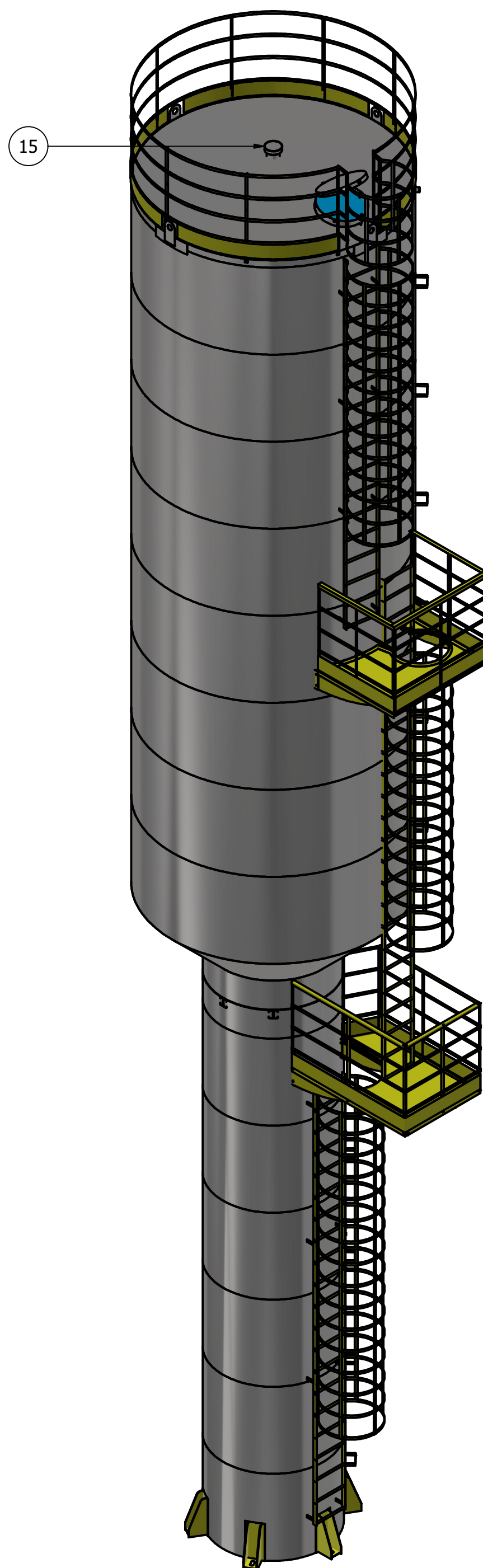
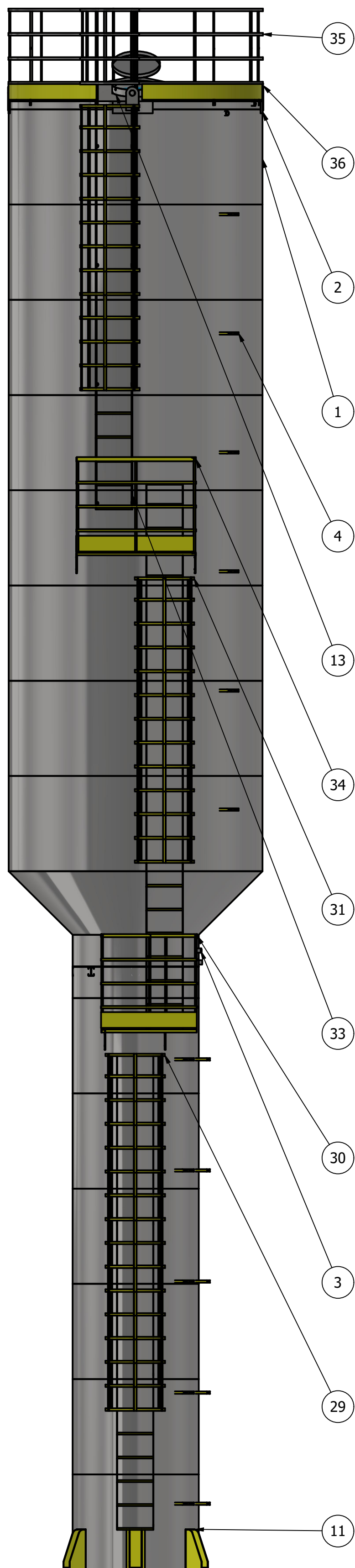

4

3

2

1

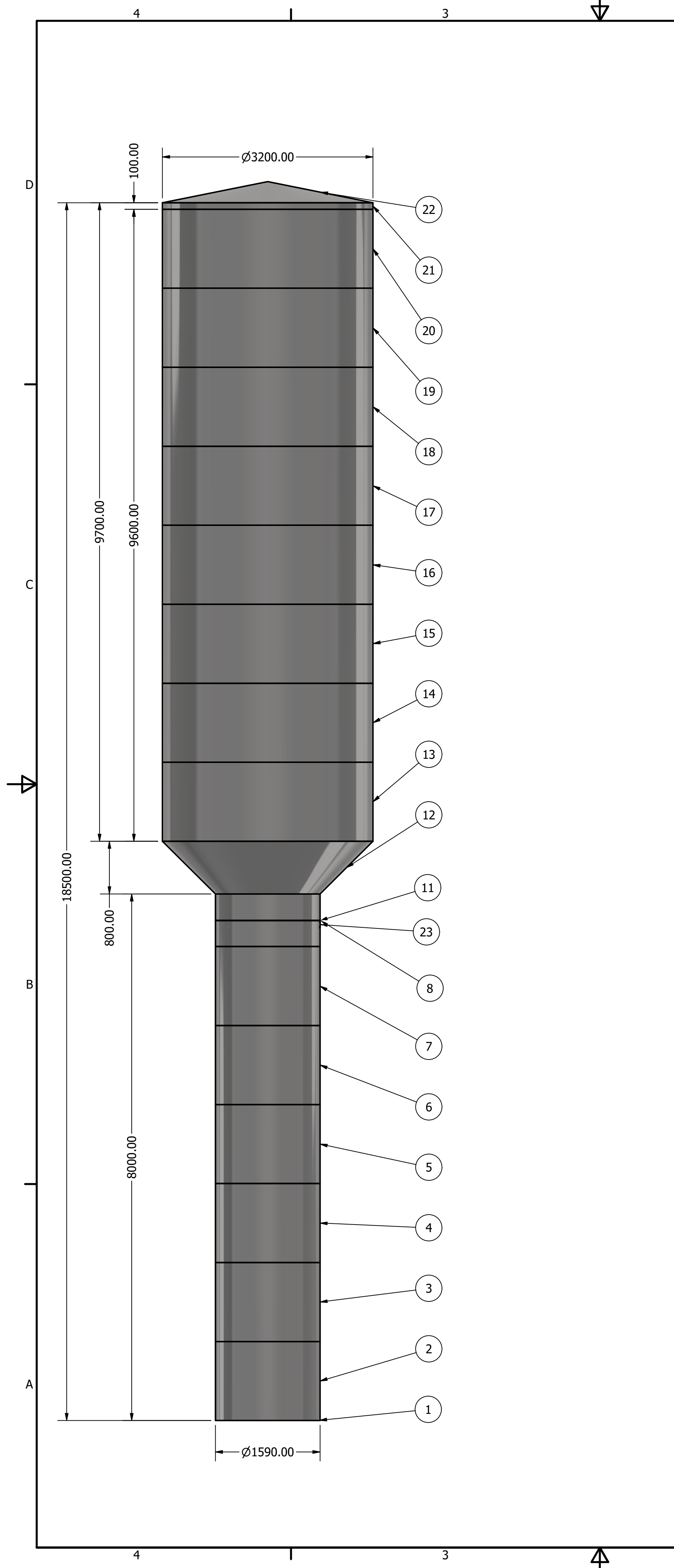

LISTA DE PEÇAS				
ITEM	QTD	NÚM. DE PEÇA	PROJETO	MASSA
1	1	01	9,00 mm	58,992 kg
2	1	02	12,70 mm	592,814 kg
3	1	03	12,70 mm	592,814 kg
4	1	04	12,70 mm	592,814 kg
5	1	05	7,94 mm	371,744 kg
6	1	06	7,94 mm	371,744 kg
7	1	07	7,94 mm	371,744 kg
8	1	08	7,94 mm	247,829 kg
11	1	11	8,00 mm	124,693 kg
12	1	12	6,35 mm	423,266 kg
13	1	13	6,35 mm	600,153 kg
14	1	14	6,35 mm	600,153 kg
15	1	15	6,35 mm	600,153 kg
16	1	16	4,75 mm	449,158 kg
17	1	17	4,75 mm	449,158 kg
18	1	18	4,75 mm	449,158 kg
19	1	19	4,75 mm	449,158 kg
20	1	20	4,75 mm	449,158 kg
21	1	21	4,75 mm	37,430 kg
22	1	22	4,75 mm	305,679 kg
23	4	TRAVAMENTO FUNDO VIGA G 40x100x40 #6,35		35,898 kg

